

VILLA MAGNA

ECO-RESORT



BLOCK C APARTMENT C.1.1 T1

 FIRST FLOOR

 GCA* 74.93 sqm

 1 PARKING SPOT

* GCA - Gross Construction Area

LOCATION

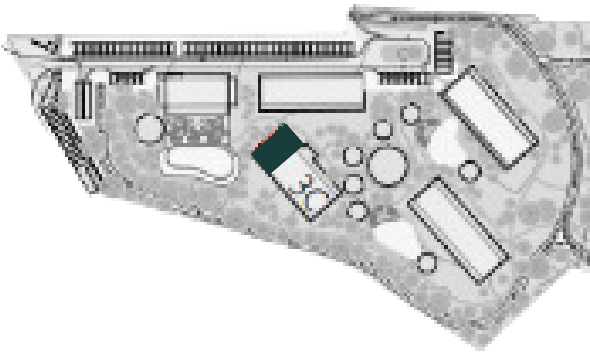

AMENITIES



SWIMMING POOL



BAR



FULLY FURNISHED



HEALTH CLUB



2 RESTAURANTS



SPORTS VILLAGE

DEVELOPER

LIVING GROUP
PAGANI CAPITAL, SGPS

ARCHITECTURE &
INTERIOR DESIGN

GAVINHO

LEGAL NOTICE: The information and images contained in this plan are merely indicative and may be subject to changes or variations due to technical, constructive or legal requirements.